

FORM NO. 1.

formerly McCall's Land
late Jn^o & Tho^s McHaffey's
Now Matthew Irvins

Courses & Distances down the
River from the Hem^s to the Wok.

- N. 10. W. 14
- N. 84. W. 42
- N. 6 E. 36
- N. 24. W. 36
- North 23.9
- N. 52. W. 27
- S. 78. W. 32
- S. 84. W. 34
- N. 60. W. 18
- N. 20. W. 27
- N. 30. E. 22
- N. 56. E. 30
- N. 77. E. 18
- N. 83. E. 20
- N. 82. E. 80
- N. 48. E. 117
- N. 44. E. 40
- N. 20. E. 20
- N. 10. W. 60
- N. 57. W. 16.

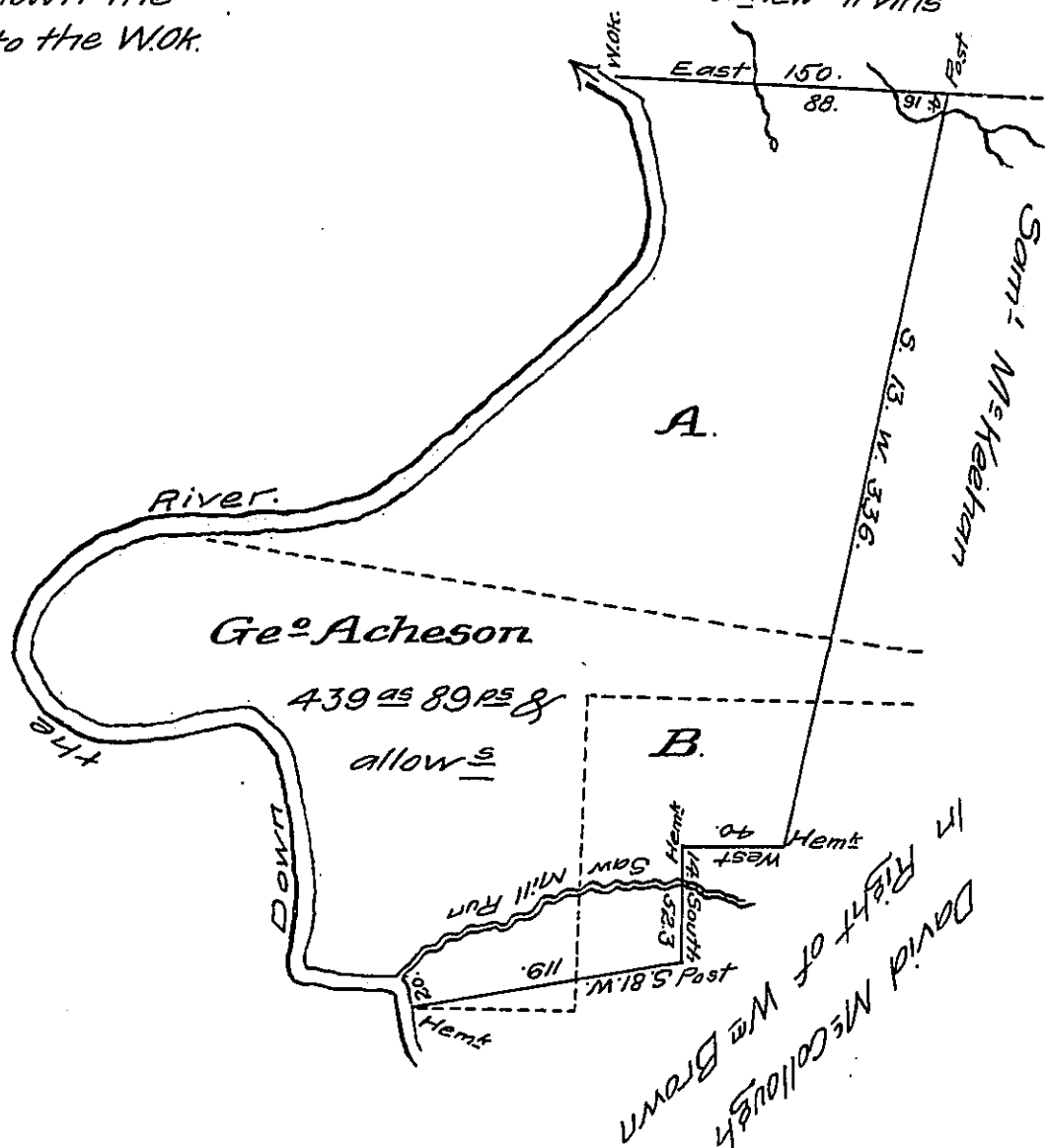

Situate in Burnside Township Clearfield County on the West branch of the Sisquahanna Containing four hundred & thirty nine acres & eighty nine perches & the usual allowance for Roads &c. Surveyed the 19th day of January 1838 by Virtue of a Warrant dated the 13th of December 1837 for 400^{ac} Including an actual Settlement Improvement begun in May 1810.

To John Taylor Esqr.
Surveyor General

Sam^l Fulton D.S.

Note 1st That part Included by the Doted line Marked A is claimed by Sam^l McKeenan by Improvement.

Note 2nd That part Included in the Doted lines Marked B is claimed by David McCollough in Right of W^m Brown on a Survey made in 1828 on Brown's W^t dated the 3rd of May 1773 by Mc Ferguson

S. F.

IN TESTIMONY that the above is a copy of the original remaining on file in the Department of Internal Affairs of Pennsylvania, made conformably to an Act of Assembly approved the 16th day of February 1833, I have hereunto set my hand and caused the Seal of said Department to be affixed at Harrisburg, this eighteenth day of October 1907

Henry Howick

Secretary of Internal Affairs.